

Flute Station™ Assembly

To create the basic set up of the full Flute Station™, there are three parts needed:

- 227060 - Burnishing Column
- 227059 - Big Block Stanchion and Turret
- 227058 - Base

Item #227059 breaks down into 2 parts: the Big block, and the turret. The turret then breaks down into two parts, which will be referred to as section A and section B.

1. Remove the screw from the bottom of section B. Detach section B and set aside.

Note: The ball bearing between the two parts may fall out when detaching. Be sure to put this back in place.

2. Remove the 2 screws from the bottom of section A and detach from the big block.
3. Attach section A to the bottom of the base (the side without pins) using the screws that were removed during step 2.

Note: Make sure all parts are clear of any debris during the steps of re-attachment.

4. Attach section B to the bottom of section A. While tightening the screw, be sure to hold in the turret release button. Check the turret's functionality after tightening. If the turret won't move freely, loosen the screw (a small amount at a time) until it turns easily.
5. Attach the big block to the base by placing the big block on top of the pins of the base. Then, install the screws into the bottom of the base.
6. To attach the column, remove the screw that is securing the T-nut. Then, locate the column to the base by placing the column in the back slot of the base. Insert the T-nut from the bottom, into the T-slot and install the screw.

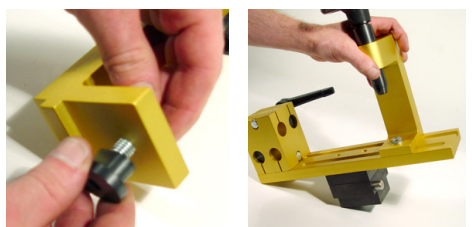
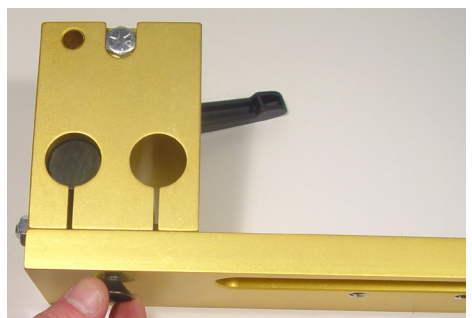
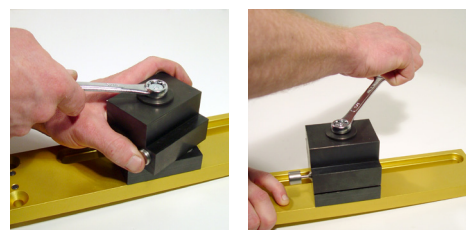
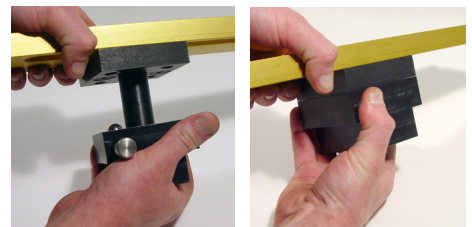
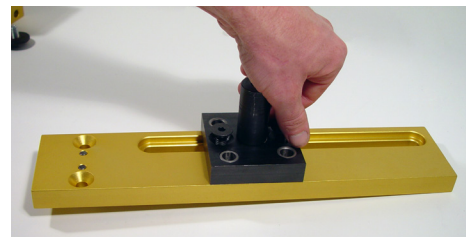
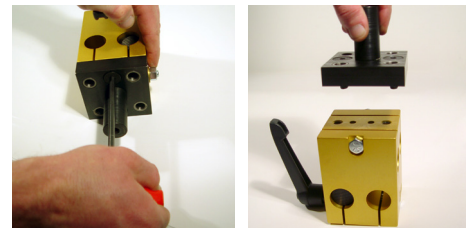
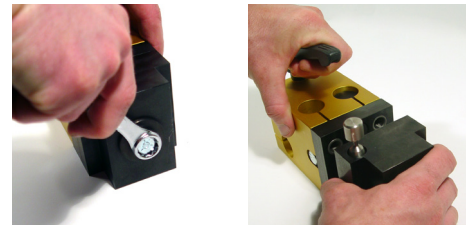
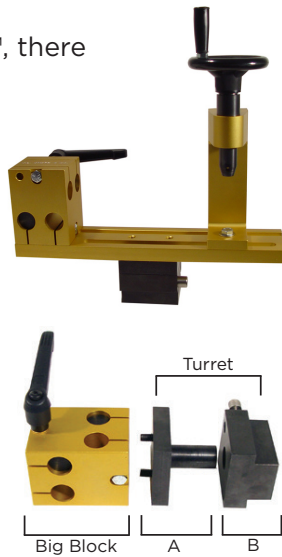

Small Flute Station™ Assembly

The small Flute Station™ comes with two pieces:

- Small Block
- Base

1. Place the base on its side with its pins facing to the left.
2. Place the small block on top of the pin closest to you.
3. Insert screw and tighten.

